

Town & Country

Estate & Letting Agents



Trem Y Wawr, Arddleen, Llanymynech, SY22 6RX

WITH NO ONWARD CHAIN!! Town and Country Oswestry offer this spacious, recently renovated detached bungalow located in a tucked away position set in good sized grounds in the pretty village of Arddleen set between Welshpool and Oswestry. The property offers large, bright rooms with three bedrooms (one ensuite) and modern kitchen and bathrooms. Externally there is parking for numerous cars along with gardens that extend all the way around the property. All amenities and good road links are within easy reach.

£375,000

- NO ONWARD CHAIN!!
- Large Detached Bungalow
- Extensive Gardens
- Fully Modernised
- Tucked Away Position
- Three Bedrooms
- Ample Parking
- Spacious Rooms
- Modern Kitchen & Bathrooms

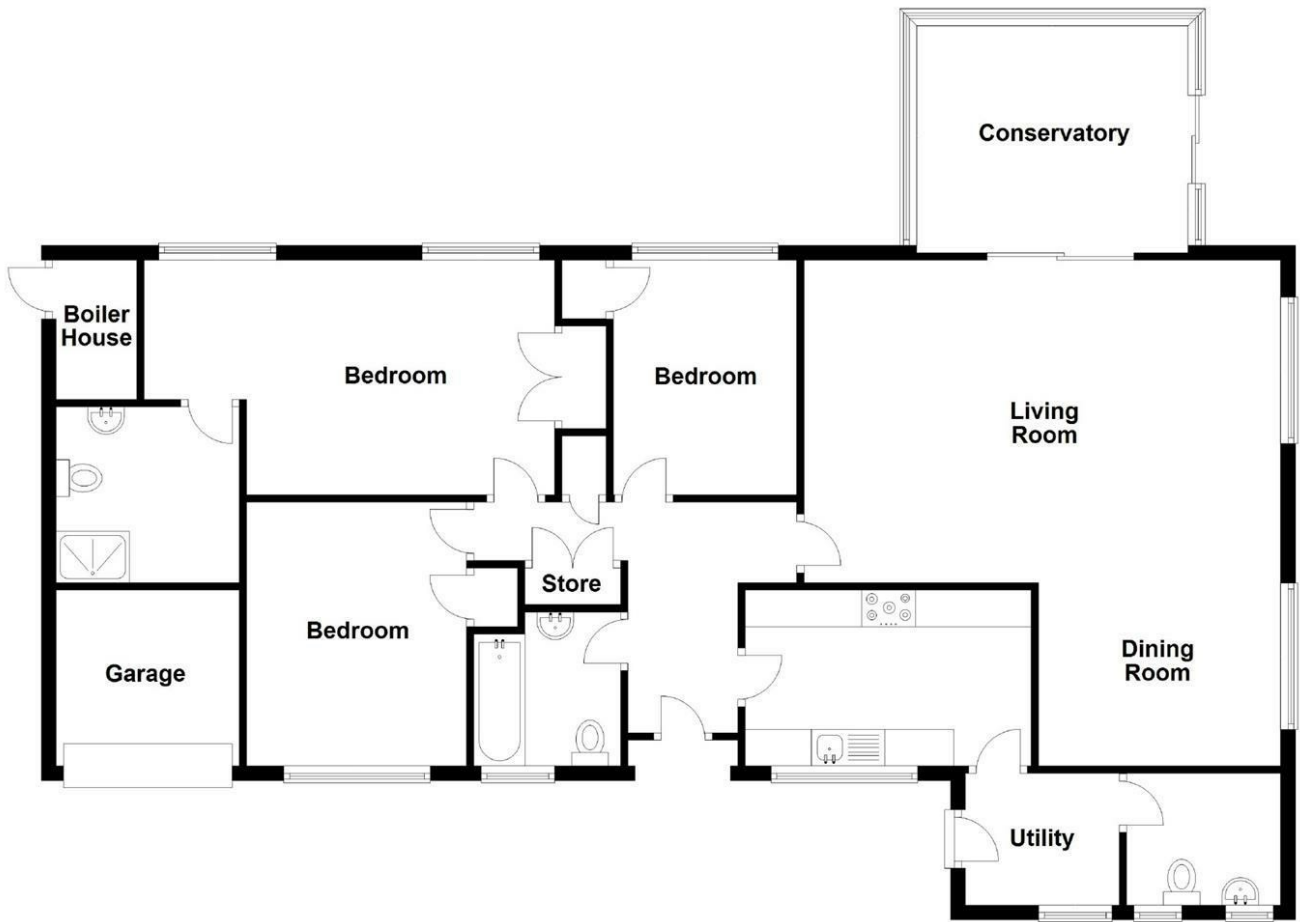

Ground Floor

Approx. 135.2 sq. metres (1455.8 sq. feet)

Total area: approx. 135.2 sq. metres (1455.8 sq. feet)

Energy Efficiency Rating		Current	Potential
<i>Very energy efficient - lower running costs</i>			
(92 plus) A			
(81-91) B			
(69-80) C			
(55-68) D			
(39-54) E			
(21-38) F			
(1-20) G			
<i>Not energy efficient - higher running costs</i>			
England & Wales	EU Directive 2002/91/EC		